

**B24,B27**

**ASSEMBLY INSTRUCTIONS**

**Getting started:**

Prepare a solid surface with protection layer to assemble on.

STEP 1: Join side panel with back panel.

STEP 2: Join bottom panel with side panel.

STEP 3: Join side panel with bottom and back panel.

STEP 4: Attach face-frame and toe-kick board.

STEP 5: Join the drawer together, then install the drawer guide.

STEP 6: Attach the wooden corner blocks on the top corners, then put in the adjustable shelves.

STEP 7: Fix drawer head on the drawer front and fix doors onto the face-frame and adjust the cover-space.

PARTS LIST		
NO.	Description	QTY
1	FACE FRAME	1
2	DRAWER BOX BOTTOM	1
3	DRAWER BOX SIDE	2
4	DRAWER BOX FRONT AND BACK	2
5	BACK PANEL	1
6	ADJUSTABLE SHELF	1
7	TOP&BOTTOM PANEL	1
8	SIDE PANEL	2
9	TOE KICK	1
10	CABINETS DOOR	2
11	DRAWER HEAD	1

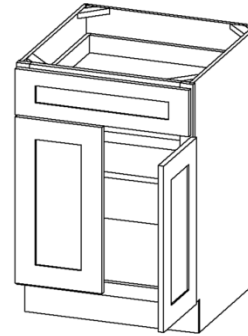

12	1 1/2" SOFTCLOSE HINGE	4	
11	3/4" ROUND HEAD SCREW	4	
10	BUMPER	8	
9	DAMPER	2	
8	1" ROUND HEAD SCREW	4	
7	Selfclose slider	1	
6	SHELF CLIP	4	
5	9/16" ROUND HEAD SCREW	55	
4	CLEAT AND BUCKLE	11	
3	1" FLAT HEAD SCREW FOR CARCASS	3	
2	WOOD BLOCK	4	
1	1" FLAT HEAD SCREW FOR WOOD BLOCK	8	
NO.	Description	QTY	PICTURE

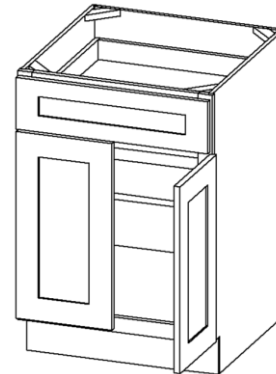
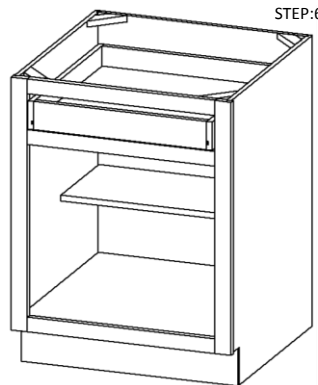
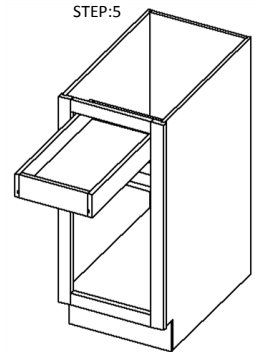
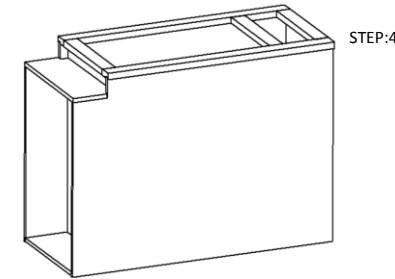
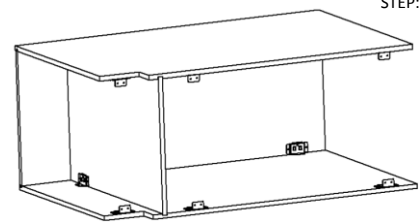
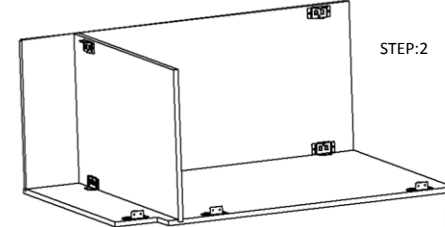
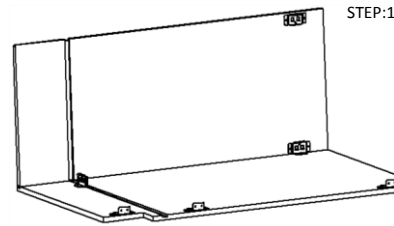

**Full extension concealed drawer runners**

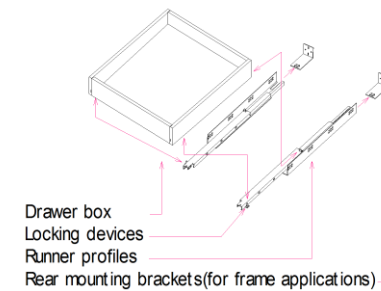

**How To Fix Soft Close Hinge**

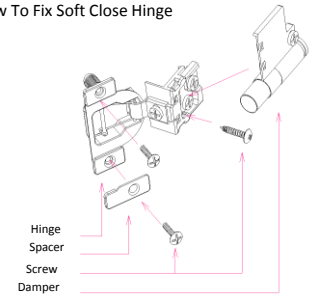

**HARDWARE LIST**